

## How to secure the fiber optic cable in the junction box



## How to secure the fiber optic cable in the junction box



Learn everything about fiber termination boxes—types, installation steps, and maintenance tips to ensure reliable fiber optic network performance.

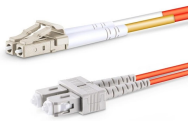

Learn how to professionally install a fiber optic junction box - a simple step-by-step guide.

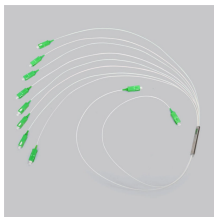

The installation of an optical cable junction box is crucial in ensuring the integrity and performance of optical networks. As we enter 2024, adhering to best practices not only enhances system reliability ...



Thus, a fiber termination box is used to terminate the optical fiber cables in the field and connect them to the pigtail by splicing. After an optical cable arrives at the user's end, it is fixed in the ...



Fiber termination box is an essential component in fiber optic communication systems that facilitates the routing and protection of fiber optic cables. The following steps provide a detailed ...

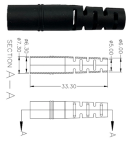

Learn the essential steps for installing an OPGW cable joint box, including preparation, mounting, fiber splicing, and sealing techniques, to ensure reliable and secure fiber optic connections ...



Use only shielded cable. Temperatures at the cable entry can reach 80° C. Selection of cable must be appropriate for the ambient temperature range in which the product is used.

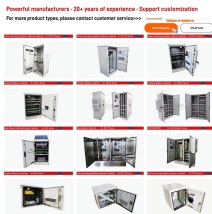

After the optical fiber distribution box is fixed on the rack, the optical cable can be introduced into the distribution box through the cable inlet hole. At this time, we need to prepare a ...



Proper installation and maintenance of fiber optic termination boxes is critical to ensuring the reliability, performance and longevity of your fiber optic network.

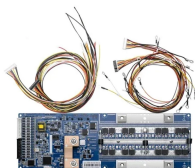

Learn the essential steps for installing an OPGW cable joint box, including preparation, mounting, fiber splicing, and sealing techniques, to ensure ...



By adhering to best practices and leveraging advanced adhesive solutions, manufacturers and professionals can ensure the longevity, performance, and reliability of their fiber optic infrastructure.

## Contact Us

For more information, pricing, or custom network solutions, please contact us:

Website: <https://hashherbcafe.co.za>

Email: [hello@hashherbcafe.co.za](mailto:hello@hashherbcafe.co.za)

Phone: +27 63 814 7295

Address: 15 Galaxy Road, Linbro Business Park, Johannesburg, 2065, South Africa

This document is for informational purposes only. Specifications subject to change without notice.

