

# **German Fireproof Channel Cable Tray Models**



## German Fireproof Channel Cable Tray Models



Up to 6 in. by 24 in. steel or aluminum cable tray with max. 45% cable fill F-Rating: 2 h; T-Rating: 0 h Max. opening size: 384 in.<sup>2</sup> with a max. dimension of 32 in. Floor ...



Up to 6 in. by 24 in. steel or aluminum cable tray with max. 45% cable fill F-Rating: 2 h; T-Rating: 0 h Max. opening size: 384 in.<sup>2</sup> with a max. dimension of 32 in. Floor or wall of min. 4 ½ in. thick ...

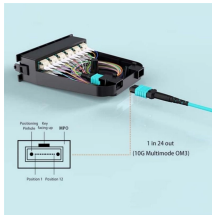

These manufacturers offer a wide range of cable tray systems, catering to diverse industry needs and adhering to stringent international standards for safety and performance.



Basor Electric, sensitive to the need to minimize the consequences of a fire, has subjected its cable trays to rigorous fire resistance tests to ensure the behavior of its products.



Compatible with the individual channel types, we also offer the various support structures in several surface finishes. The range extends from strip galvanized to hot-dip galvanized steel and stainless steel.



RS 60.300 OV Cable tray, heavy, 60x300x3000 mm, perforated, steel, pre-galvanised according to DIN EN 10346, without connector Add to Cart €0.00 Excl. 0% VAT EAN 4013339248407 RS 60.100 F OV ...



The GR-Magic® mesh cable tray has been tested as a cable-specific support construction for the maintenance of electrical function according to DIN 4102 Part 12 and approved for maintenance of ...



They are available in perforated (RG) or non-perforated (R) versions, in heavy-duty versions (RS/RGS), for use under sprinkler systems (RGL) or as installation cable trays (RI/RIS).



Meka Pro regularly tests the fire resistance of its products to ensure high-quality and safe cable management systems. The products are tested extensively and using several different installation ...

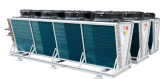

This article will explore the leading cable tray manufacturers in Germany, examining their products, technological advancements, and why they are trusted by industries worldwide.



Our KBSCL cable tray is now available in zinc magnesium (ZM). Thanks to its unique chemical composition zinc magnesium offers a better resistance against corrosion than standard hot-dipped steel.

## Contact Us

For more information, pricing, or custom network solutions, please contact us:

Website: <https://hashherbcafe.co.za>

Email: [hello@hashherbcafe.co.za](mailto:hello@hashherbcafe.co.za)

Phone: +27 63 814 7295

Address: 15 Galaxy Road, Linbro Business Park, Johannesburg, 2065, South Africa

This document is for informational purposes only. Specifications subject to change without notice.

