

## Distribution Box DB-

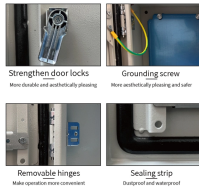

## Distribution Box DB-



This ultimate guide explains what a distribution box does, its internal components, common types, real-world applications, and how to select the right DB Box for your project.



A distribution box (DB box) is a key part of electrical wiring, acting as a central hub where cables branch out to various outlets and switches in a building. It supports different cable sizes and ...



At its core, a DB Box is a vital component of any electrical system. It acts as the central hub, ensuring electricity is distributed safely and efficiently from a main power source (such as a ...



They are distribution boxes (DB box), also known as distribution panels, which distribute electricity throughout a building or residence. This article will provide a detailed introduction to ...

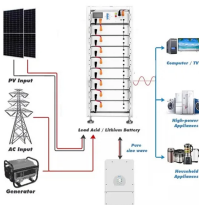

Understand distribution boxes (DB boxes) in 5 minutes. Learn about types, components, functions, and uses. Find the perfect DB box for your needs.



Q: What is a power distribution box (DB box) and why is it important in event technology? A: A power distribution box, or DB box, is a device used to distribute electrical power safely and efficiently at events.



Engineered for modern electrical and solar installations, the Concealed Distribution Box 10×14 provides a reliable, sleek solution for safe circuit management. Ideal for embedding into walls, this flush-mount ...



This distribution box controls and distributes power to lighting systems in commercial buildings and residential complexes. It can control the lighting levels, schedule, and other parameters.

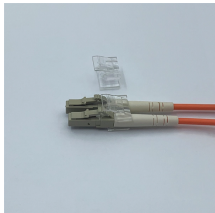

A distribution box (distribution board/DB box) distributes incoming power to multiple circuits and typically houses protective devices such as breakers and optional leakage/surge protection.



In the world of electrical installations, the term DB box —short for Distribution Board box —refers to the central unit that distributes incoming electrical power to multiple outgoing circuits in a building.

## Contact Us

For more information, pricing, or custom network solutions, please contact us:

Website: <https://hashherbcafe.co.za>

Email: [hello@hashherbcafe.co.za](mailto:hello@hashherbcafe.co.za)

Phone: +27 63 814 7295

Address: 15 Galaxy Road, Linbro Business Park, Johannesburg, 2065, South Africa

This document is for informational purposes only. Specifications subject to change without notice.

