

## Common Circuit Components in Secondary Distribution Boxes

Component Diagram

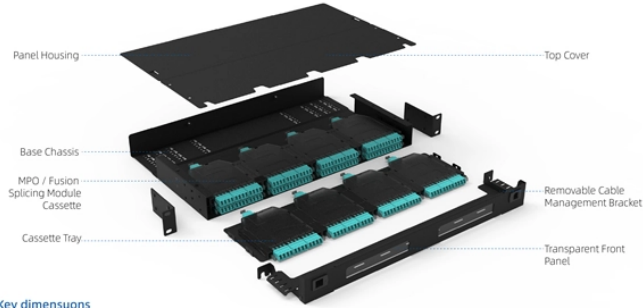

Key dimensions

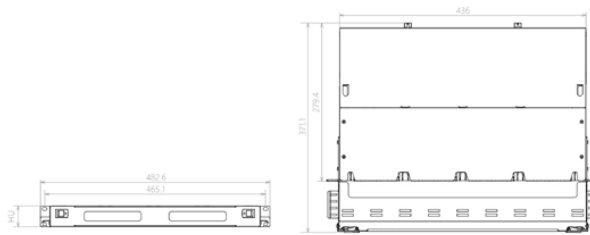

## Common Circuit Components in Secondary Distribution Boxes



From breakers and bus bars to neutral and ground bars, we will explore each component of an electrical sub panel and explain how they work together to distribute electricity efficiently and safely.



This ultimate guide explains what a distribution box does, its internal components, common types, real-world applications, and how to select the right DB Box for your project.



The main parts are the Miniature Circuit Breaker (MCB), Residual Current Device (RCD), busbars, and the main switch. Safe habits and checking the box often help stop electrical accidents.



Essential components include miniature circuit breakers (MCBs), residual current devices (RCDs/RCBOs), busbars, and Surge Protective Devices (SPDs). Proper integration of these ...



Learn everything about the Distribution Box, its key components, and how to choose the right one. Explore our quality products and upgrade your electrical system today!



It acts as a protective enclosure that houses several key components, such as circuit breakers, fuses, and bus bars. These components work together to prevent electrical faults, such as ...



Learn what an electrical distribution box (DB/distribution board) is, its main components (MCB/RCCB/RCBO, SPD, busbar) and common types. Includes a quick selection guide for ways, IP ...



Here, we provide an overview of common substation busbar configurations—Single Bus, Main and Transfer, Double Breaker/Double Bus, Ring Bus/Ring Main, and Breaker and a Half.

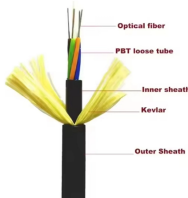

Primary windings are comprised of wire conductors, either aluminum or copper. Secondary windings are either full height sheet conductors or wire conductor dependent on the ...



A grid networks consist of an interconnected grid of circuits, energized from several primary feeders through distribution transformers at multiple locations. Grid networks are typically ...

## Contact Us

For more information, pricing, or custom network solutions, please contact us:

Website: <https://hashherbcafe.co.za>

Email: [hello@hashherbcafe.co.za](mailto:hello@hashherbcafe.co.za)

Phone: +27 63 814 7295

Address: 15 Galaxy Road, Linbro Business Park, Johannesburg, 2065, South Africa

This document is for informational purposes only. Specifications subject to change without notice.

