

Changing Aluminum Alloy Cable Tray Manufacturer

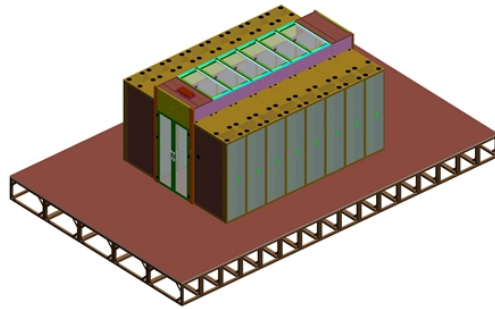

Changing Aluminum Alloy Cable Tray Manufacturer



Made from aluminum alloy, these rugged components bolt together to form a solid and reliable cable pathway. To secure and protect your infrastructure cables, RXL offers high quality aluminum cable ...



If your project requires lightweight, corrosion-resistant, and thermally optimized cable management, our engineers can guide you in selecting the perfect aluminum alloy cable tray system.



The Aluminum Cable Ladder has a high loading capacity to manage dense cable transitions. Designed with a lightweight structural design, easy installation, and long-lasting corrosion resistance, the ...



Aluminum Cable Tray systems are lighter than steel cable tray and Certified CSA Cable Tray, UL listed, NEMA and certified. Because of their lighter weight aluminum cable trays are easier to install than ...



Aluminum cable trays of NewReach are built in the USA and tested to meet UL, CSA, NEMA, NEC, and ISO, and CE standards. It ensures safety, efficiency, and long-lasting performance for industrial and ...



The aluminum cable tray is a lightweight, durable, and cost-effective solution used for organizing and safely carrying electrical and data cables. With easy installation and strong corrosion resistance, it is ...



We offer modern, innovative, and technically advanced cable trays, tray covers and wire management accessories, support, and logistics management with an emphasis on customer service.



As a less-expensive alternative to conduit, a stronger alternative than wire basket, and superior to generic tray, Snap Track saves on labor and reduces total installed costs.



PowerTray is a versatile Aluminum Ladder Tray system available in a broad range of NEMA and CSA Load classes. A full line of accessories, covers, and radius fittings are available including “snap-in” ...



Custom manufacturer of cable trays made from aluminum, fiberglass reinforced plastic (FRP), galvanized and stainless steel materials. Suitable for supporting insulated electrical cables.

Contact Us

For more information, pricing, or custom network solutions, please contact us:

Website: <https://hashherbcafe.co.za>

Email: hello@hashherbcafe.co.za

Phone: +27 63 814 7295

Address: 15 Galaxy Road, Linbro Business Park, Johannesburg, 2065, South Africa

This document is for informational purposes only. Specifications subject to change without notice.

