

BBU direct-connection RTU optical cable connector type

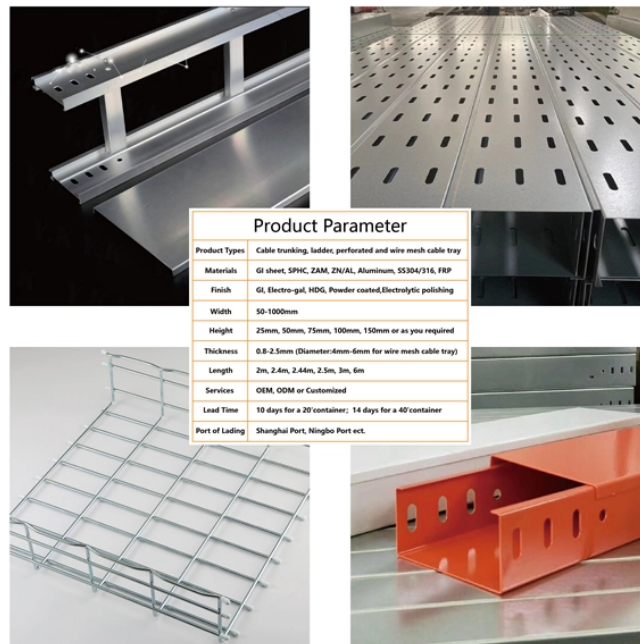

Overview

A CPRI (Common Public Radio Interface) fiber optic patch cord is a specialized type of fiber optic cable used to connect remote radio units (RRUs) with baseband units (BBUs) in mobile networks. A CPRI cable is a fiber optic cable assembly used to carry fronthaul signals between baseband equipment (BBU) and remote radio equipment (RRU/RRH) in mobile networks, following the Common Public Radio Interface (CPRI) specification. Designed for Ericsson base station functionality. LC duplex connectors on both ends Duplex LC-to-Duplex LC type cable, 4. 8mm outer diameter and LSZH outdoor ready jacket. Other multicore versions of 4. The 5G Base Station Optical J599 D38999 24-core Connector RRU BBU CPRI Fiber Optic Cable is designed for outdoor use and offers high-performance connectivity in demanding environments. The J599 waterproof fiber optic connector features a tri-start thread and five-key positioning, which prevents. Radio Remote Unit (RRU) is the distributed and integrated frequency unit that connects to an operators network with the User Equipment's (UE's) like Cell Phone and mobile devices. Such product can meet the FTTA (fiber to the Antenna) program requirements for outdoor environment conditions. CPRI fiber patch cable are.

BBU direct-connection RTU optical cable connector type



RRU & BBU Fiber Cable Installation Guide This document provides guidelines for distributing and connecting optical fiber cables between remote radio units (RRUs) and baseband units (BBUs).



A CPRI (Common Public Radio Interface) fiber optic patch cord is a specialized type of fiber optic cable used to connect remote radio units (RRUs) with baseband units (BBUs) in mobile networks.

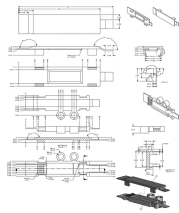

The connection to the RTU560 communication units is made with up to eight connectors to slots occupied by CMUxx Modules. Two connector cables are delivered with the 560BCU05 R0001.



A CPRI (Common Public Radio Interface) fiber optic patch cord is a ...



A CPRI cable is a fiber optic cable assembly used to carry fronthaul signals between baseband equipment (BBU) and remote radio equipment (RRU/RRH) in mobile networks, following the ...



CPRI Optic Patch Cord with flexible boots is the ideal design for outdoor fiber cable applications. Such product can meet the FTTA (fiber to the Antenna) program requirements for outdoor environment ...



The optical interface link is also known as CPRI (Common Public Radio Interface). CPRI is a interface protocol developed by combination of major telecom equipment's manufacturing company.



Optical fiber patchcord for typical interconnection between RRU and BBU. CPRI, ...



One BBU connects to three RRUs (in general cases, excluding remote scenarios or situations in 3G where some macro stations correspond to four cells). One RRU corresponds to one ...



The 5G Base Station Optical J599 D38999 24-core Connector RRU BBU CPRI Fiber Optic Cable is designed for outdoor use and offers high-performance connectivity in demanding environments.



RRU & BBU Fiber Cable Installation Guide This document provides guidelines for distributing and connecting optical fiber cables between remote radio units ...



Optical fiber patchcord for typical interconnection between RRU and BBU. CPRI, LTE and 5G ready. Designed for Ericsson base station functionality. LC duplex connectors on both ends.



According to the polishing type, optical fiber cable connectors can be divided into APC connector and UPC connector. The main difference lies in APC connector vs UPC connector is the fiber endface.



The 5G Base Station Optical J599 D38999 24-core Connector RRU BBU CPRI Fiber Optic Cable is designed for outdoor use and offers high-performance connectivity ...

Contact Us

For more information, pricing, or custom network solutions, please contact us:

Website: <https://hashherbcafe.co.za>

Email: hello@hashherbcafe.co.za

Phone: +27 63 814 7295

Address: 15 Galaxy Road, Linbro Business Park, Johannesburg, 2065, South Africa

This document is for informational purposes only. Specifications subject to change without notice.

